

Case Study – Development



Project: Urban Outfitters Distribution Warehouse, White Township, PA
Product: Premier 8
Manufacturer: Beavertown Block Company
Design: French & Parrello Associates
Contractor: Proscap
Total Area: 26,080 sq. ft.
Wall Heights: 5 to 37 ft. vertical

Design Challenge:

This project required a fast-rack solution and needed to be completed rapidly. The design called for 6 separate walls ranging in height from 5' to 37 feet.

Design Solution:

The developer chose Rockwood's Premier® 8 block for its proven strength, design versatility, lightweight advantages and economic solution.

The Result:

Its 54 lb. unit weight reduced installer fatigue and cut construction time significantly. At 860 sq. ft./load, the freight cost savings alone gave the contractor a substantial project bid advantage.



Premier™ 8

Premier 8, Rockwood's unique and patented block design is changing the SRW industry. Its 54 lb. unit weight beats all other block systems for strength, performance, freight efficiencies and ease of construction. Premier 8's gravel filled cores create vertical "stone columns" to create a multi-point interlock for a more uniform block-to-grid connection, the result is one of the strongest block-to-grid connections in the SRW industry.

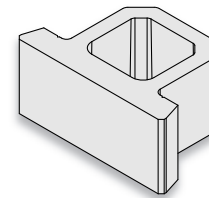

- Straight Split
- 18" W x 12" D x 8" H (45cm x 30cm x 20cm)
- 54 lbs., 24.5 kg

Appearance
Dependability
Efficiency

ROCKWOOD®
RETAINING WALLS
A better way.™

