

# CLASSIC 8 RETAINING WALL - DOT Approved

**ROCKWOOD®**  
RETAINING WALLS  
*A better way.™*

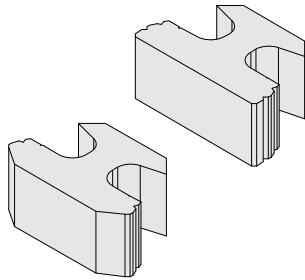

- Straight face, 1" setback; adjustable
- Beveled face\* is SPECIAL ORDER and can be made in any color. Minimum quantity required, customer must take entire production run. Returns not allowed.
- Iowa, Minnesota and Wisconsin DOT approved
- Manufactured in Thorp, WI
- Available by pallet

Colors: Sandstone, Grey

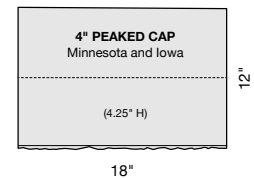
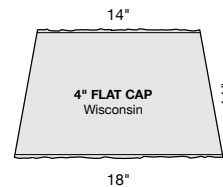

DOT Blocks/Caps	Dimensions	Face Area	Weight	Units/Layer	Layers	Units/Pallet	Pallet Weight
Straight Face	18 x 12 x 8" H	1.0 sq. ft.	87 lbs.	12	3	36 (36 sq. ft.)	3,182 lbs.
Beveled Face*	18 x 12 x 8" H	1.0 sq. ft.	82 lbs.	12	3	36 (36 sq. ft.)	3,002 lbs.
4" Flat Cap (WI)	18/14 x 11 x 4" H	1.33 ln. ft.	55 lbs.	9	5	45 (60 ln. ft.)	2,520 lbs.
4" Peaked Cap (MN and IA)	18 W x 12 x 4" H	1.5 ln. ft.	70 lbs.	8	4	32 (48 ln. ft.)	2,290 lbs.

Dimensions shown are nominal.



Manufactured by:

7200 Broadway Ave. N, Rochester, MN 55906  
Phone: 507-288-8850 • Fax: 507-535-1487  
[rochesterpcp.com](http://rochesterpcp.com)

©Copyright 2024. All Rights Reserved. This information has been prepared for the benefit of customers interested in Rochester Concrete Products. It was reviewed carefully prior to publication. Rochester Concrete Products assumes no liability for its accuracy or completeness. Final determination of the suitability of any information or material for the use contemplated, or for its manner of use, is the sole responsibility of the user. 424

