

WALL QUICK REFERENCE GUIDE



CLASSIC 6 STRAIGHT-SPLIT



- One-Sided
- Applications: Retaining
- Setback/Batter: 0.75" / 7.1°
- Radius: 6' Minimum Top of Wall
- Cap With: Contemporary, 4" Universal

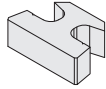

Blocks	Dimensions	Face Area	Weight	Units/Layer	Layers	Units/Pallet	Pallet Weight
Straight Face	18 x 12 x 6" H	0.75 sq. ft.	64 lbs.	12	3	36 (27 sq. ft.)	2,354 lbs.
Straight Base (grey only)	18 x 12 x 6" H	0.75 sq. ft.	64 lbs.	12	3	36 (27 sq. ft.)	2,354 lbs.
Solid Corner Block**	18 x 9 x 6" H	0.66 sq. ft.	76.6 lbs.	5	4	20 (13.2 sq. ft.)	1,582 lbs.

CLASSIC 6 BEVELED



- One-Sided
- Applications: Retaining
- Setback/Batter: 0.75" / 7.1°
- Radius: 6' Minimum Top of Wall
- Cap With: Contemporary, 4" Universal



Blocks	Dimensions	Face Area	Weight	Units/Layer	Layers	Units/Pallet	Pallet Weight
Beveled Face	18 x 12 x 6" H	0.75 sq. ft.	60 lbs.	12	3	36 (27 sq. ft.)	2,210 lbs.
Straight Base (grey only)	18 x 12 x 6" H	0.75 sq. ft.	64 lbs.	12	3	36 (27 sq. ft.)	2,354 lbs.
Solid Corner Block**	18 x 9 x 6" H	0.66 sq. ft.	76.6 lbs.	5	4	20 (13.2 sq. ft.)	1,582 lbs.

CLASSIC 8 STRAIGHT-SPLIT



- One-Sided
- Applications: Retaining
- Setback/Batter: 1" / 7.1°
- Radius: 6' Minimum Top of Wall
- Cap With: Contemporary, 4" Universal



Blocks	Dimensions	Face Area	Weight	Units/Layer	Layers	Units/Pallet	Pallet Weight
Straight Face	18 x 12 x 8" H	1.0 sq. ft.	85 lbs.	12	3	36 (36 sq. ft.)	3,110 lbs.
Straight Base (grey only)	18 x 12 x 8" H	1.0 sq. ft.	85 lbs.	12	3	36 (36 sq. ft.)	3,110 lbs.
Solid Corner Block**	18 x 9 x 8" H	1.0 sq. ft.	103.4 lbs.	5	4	20 (20 sq. ft.)	2,118 lbs.

CLASSIC 8 BEVELED



- One-Sided
- Applications: Retaining
- Setback/Batter: 1" / 7.1°
- Radius: 6' Minimum Top of Wall
- Cap With: Contemporary, 4" Universal



Blocks	Dimensions	Face Area	Weight	Units/Layer	Layers	Units/Pallet	Pallet Weight
Beveled Face	18 x 12 x 8" H	1.0 sq. ft.	79 lbs.	12	3	36 (36 sq. ft.)	2,895 lbs.
Straight Base (grey only)	18 x 12 x 8" H	1.0 sq. ft.	85 lbs.	12	3	36 (36 sq. ft.)	3,110 lbs.
Solid Corner Block**	18 x 9 x 8" H	1.0 sq. ft.	103.4 lbs.	5	4	20 (20 sq. ft.)	2,118 lbs.

CLASSIC 8 DOT & CAPS

- One-Sided
- Applications: Retaining
- Setback/Batter: 1" / 7.1°
- Radius: 6' Minimum Top of Wall
- Cap With: DOT Approved Universal or Peaked

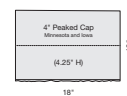
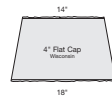
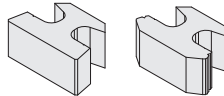

Blocks/Caps	Dimensions	Face Area	Weight	Units/Layer	Layers	Units/Pallet	Pallet Weight
Straight Face	18 x 12 x 8" H	1.0 sq. ft.	87 lbs.	12	3	36 (36 sq. ft.)	3,182 lbs.
Beveled Face (special order)	18 x 12 x 8" H	1.0 sq. ft.	82 lbs.	12	3	36 (36 sq. ft.)	3,002 lbs.
4" Flat Cap (WI)	18/14 x 11 x 4" H	1.33 sq. ft.	55 lbs.	9	5	45 (60 sq. ft.)	2,520 lbs.
4" Peaked Cap (MN and IA)	18 W x 12 x 4" H	1.5 sq. ft.	70 lbs.	8	4	32 (48 sq. ft.)	2,290 lbs.

Dimensions shown are nominal. Corners are split on one long and one short side. ** Rochester and Beaver Dam only.

ROCKWOOD®
RETAINING WALLS
A better way.™

CLASSIC 6 COLONIAL



- One-Sided
- Applications: Retaining
- Setback/Batter: 0.75" / 7.1°
- Radius: 6" Minimum Top of Wall
- Cap With: Contemporary, 4" Universal

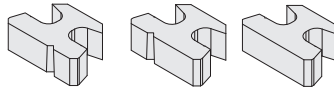

Blocks	Dimensions	Face Area	Weight	Units/Layer	Layers	Units/Pallet	Pallet Weight
Colonial 18	18 x 12 x 6" H	0.75 sq. ft.	60 lbs.	12	3	36 (27 sq. ft.)	2,260 lbs.
Colonial 6/12 (left and right)	18 x 12 x 6" H	0.75 sq. ft.	60 lbs.	12	3	36 (27 sq. ft.)	2,260 lbs.
Base Block (grey only)	18 x 12 x 6" H	0.75 sq. ft.	60 lbs.	12	3	36 (27 sq. ft.)	2,260 lbs.

CLASSIC 8 COLONIAL (special order)

- One-Sided
- Applications: Retaining
- Setback/Batter: 1" / 7.1°
- Radius: 6" Minimum Top of Wall
- Cap With: Contemporary, 4" Universal

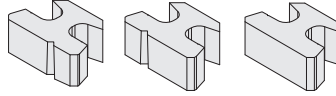

SPECIAL ORDER products can be made in any color, minimum quantity required; customer must take entire production run, returns not allowed.

Blocks	Dimensions	Face Area	Weight	Units/Layer	Layers	Units/Pallet	Pallet Weight
Colonial 18	18 x 12 x 6" H	0.75 sq. ft.	60 lbs.	12	3	36 (27 sq. ft.)	2,260 lbs.
Colonial 6/12 (left and right)	18 x 12 x 6" H	0.75 sq. ft.	60 lbs.	12	3	36 (27 sq. ft.)	2,260 lbs.
Base Block (grey only)	18 x 12 x 6" H	0.75 sq. ft.	60 lbs.	12	3	36 (27 sq. ft.)	2,260 lbs.

CONTEMPORARY



- Two-Sided
- Applications: Retaining, Seatwall, Pillar
- Setback/Batter: 0" / 0°
- Radius: N/A
- Cap With: Contemporary Cap

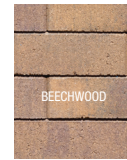
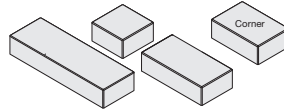

Blocks	Dimensions	Face Area	Weight	Units/Layer	Layers	Units/Pallet	Pallet Weight
Small	8 x 8 x 4" H	1.33 sq. ft./set	122 lbs./set	4 sets/layer	5	20 sets (26.6 sq. ft.)	2,480 lbs.
Medium	16 x 8 x 4" H						
Large	24 x 8 x 4" H						
Corner/Pillar Block	12 x 8 x 4" H	0.33 sq. ft.	35 lbs.	20	4	80 (26.6 sq. ft.)	2,480 lbs.
Contemporary Wall Cap*	24 W x 12 x 2-3/8" H	2 ln. ft.	50 lbs.	6	8	48 (96 ln. ft.)	2,450 lbs.

*Mocha, Natural, and Onyx colors

COTTAGE STONE & MINI-CAP

- One-Sided
- Applications: Retaining
- Setback/Batter: 0.75 / 10.6°
- Radius: 4" Minimum
- Cap With: Mini-Cap

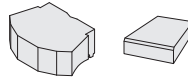

Blocks	Dimensions	Face Area	Weight	Units/Layer	Layers	Units/Pallet	Pallet Weight
Cottage Stone	12 x 8.5 x 4" H	0.33 sq. ft.	25 lbs.	16	6	96 (31.68 sq. ft.)	2,450 lbs.
Mini-Cap	8/6 x 9.25 x 3" H	0.67 ln. ft.	15.2 lbs.	52	2	104 (60 ln. ft.)	1,630 lbs.

LAKELAND



- Two-Sided
- Applications: Retaining, Seatwall, Pillar
- Setback/Batter: 0" / 0°
- Radius: N/A
- Cap With: Contemporary, 4" Universal

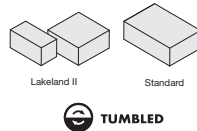

Blocks	Dimensions	Face Area	Weight	Units/Layer	Layers	Units/Pallet	Pallet Weight
Lakeland II (small)	4 x 8 x 4" H	0.33 sq. ft.	31 lbs.	20 sets	4	80 sets (26 sq. ft.)	2,530 lbs.
Lakeland II (medium)	8 x 8 x 4" H						
Lakeland Standard	12 x 8 x 4" H						

* Also available non-tumbled, Standard only.

OLYMPIC



- Two-Sided
- Applications: Retaining, Seatwall, Pillar
- Setback/Batter: 0" / 0°
- Radius: 10" Minimum
- Cap With: Contemporary

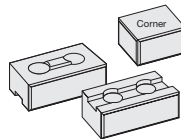

Blocks	Dimensions	Face Area	Weight	Units/Layer	Layers	Units/Pallet	Pallet Weight
Wall	17.25 x 10 x 6" H	0.72 sq. ft.	67 lbs.	12	4	48 (34.5 sq. ft.)	3,266 lbs.
Seatwall/Corner/Pillar	12 x 10 x 6" H	0.50 sq. ft.	57 lbs.	16	3	48 (24 sq. ft.)	2,785 lbs.

Dimensions shown are nominal. Corners are split on one long and one short side. ** Rochester and Beaver Dam only.

PALISADE



- One-Sided
- Applications: Retaining
- Setback/Batter: 0.75" / 5.3°
- Radius: N/A
- Cap With: Contemporary

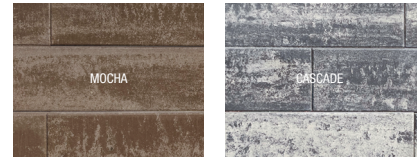
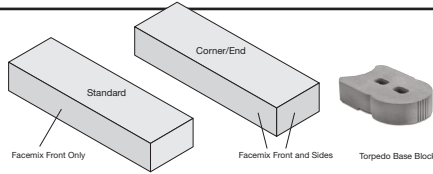

Blocks	Dimensions	Face Area	Weight	Units/Layer	Layers	Units/Pallet	Pallet Weight
Standard	40 x 12 x 8" H	2.22 sq. ft.	330 lbs.	4	2	8 (17.76 sq. ft.)	2,714 lbs.
Corner/End	40 x 12 x 8" H	2.22 sq. ft.	330 lbs.	4	2	8 (17.76 sq. ft.)	2,714 lbs.
Torpedo Base Block (gray only)	15 x 12 x 4" H	0.44 sq. ft.	47 lbs.	-	-	56 (70 ln ft.)	2,828 lbs.

PREMIER 6



- One-Sided
- Applications: Retaining
- Setback/Batter: 0.5" / 4.7°
- Radius: 6" Minimum Top of Wall
- Cap With: Contemporary, 4" Universal or Chiseled

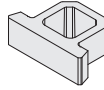

Blocks	Dimensions	Face Area	Weight	Units/Layer	Layers	Units/Pallet	Pallet Weight
Premier 6	18 x 12 x 6" H	0.74 sq. ft.	43.5 lbs.	9	5	45 (33.3 sq. ft.)	2,010 lbs.
Solid Corner Block**	18 x 9 x 6" H	0.66 sq. ft.	76.6 lbs.	5	4	20 (13.2 sq. ft.)	1,582 lbs.

PREMIER 8



- One-Sided
- Applications: Retaining
- Setback/Batter: 1" / 7°
- Radius: 6" Minimum Top of Wall
- Cap With: 4" Universal or Chiseled

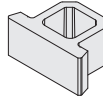

Blocks	Dimensions	Face Area	Weight	Units/Layer	Layers	Units/Pallet	Pallet Weight
Premier 8 (Rochester)	18 x 12 x 8" H	1 sq. ft.	57 lbs.	9	4	36 (36 sq. ft.)	2,102 lbs.
Premier 8 (Beaver Dam)	18 x 12 x 8" H	1 sq. ft.	57 lbs.	9	5	45 (45 sq. ft.)	2,615 lbs.
Solid Corner**	18 x 9 x 8" H	1 sq. ft.	100 lbs.	5	4	20 (20 sq. ft.)	2,050 lbs.

RIVERLAND

- Two-Sided
- Applications: Retaining, Seatwall, Pillar
- Setback/Batter: 0" / 0°
- Radius: 8" Minimum
- Cap With: N/A

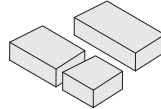

Blocks	Dimensions	Face Area	Weight	Units/Layer	Layers	Units/Pallet	Pallet Weight
Small	8 x 8 x 4" H						
Medium (3 piece set)	12 x 8 x 4" H	1.0 sq. ft.	90 lbs.	5 sets	6	30 (30 sq. ft.)	2,750 lbs.
Large	16 x 8 x 4" H						

VINTAGE 6 (straight-split or tumbled)



- Two-Sided
- Applications: Retaining, Seatwall, Pillar
- Setback/Batter: 0" / 0°
- Radius: 8" Minimum
- Cap With: 3" Universal or Chiseled

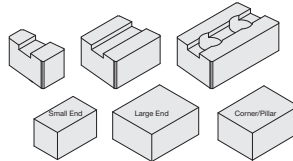

Blocks	Dimensions	Face Area	Weight	Units/Layer	Layers	Units/Pallet	Pallet Weight
Small	6 x 10 x 6" H	0.25 sq. ft.					
Medium	12 x 10 x 6" H	0.50 sq. ft.	137.5 lbs.	4 sets	5	20 sets (30 sq. ft.)	2,790 lbs.
Large	18 x 10 x 6" H	0.75 sq. ft.					
Small End Block (tumbled)	6 x 10 x 6" H	0.42 sq. ft.					
Large End Block (tumbled)	12 x 10 x 6" H	0.83 sq. ft.	81.50 lbs.	8 sets	1	8 sets	702 lbs.
Small End Block (straight-split)	6 x 10 x 6" H	0.42 sq. ft.					
Large End Block (straight-split)	12 x 10 x 6" H	0.83 sq. ft.	81.50 lbs.	8 sets	3	24 sets	2,006 lbs.
Corner (tumbled or straight-split)	12 x 9 x 6" H	0.50 sq. ft.	48 lbs.	15	2	30	1,490 lbs.

Vintage End Blocks are split three sides, Corner/Pillar Blocks split two sides.

VERSA-LOK STANDARD

- Two-Sided
- Applications: Retaining, Seatwall, Pillar
- Setback: 0.75" / 7° or Vertical
- Radius: 8" Outside, 6" Inside
- Cap With: 3" Universal or Chiseled

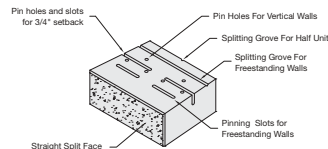

Blocks	Dimensions	Face Area	Weight	Units/Layer	Layers	Units/Pallet	Pallet Weight
Standard	14/16 W x 12 D x 6" H	0.667 sq. ft.	82 lbs.	10	4	40 (26.7 sq. ft.)	3,350 lbs.
Versa-Tuff Pin (6.8" x .48" dia.)	-	-	100/Bag				

Dimensions shown are nominal. Corners are split on one long and one short side. ** Rochester and Beaver Dam only.

RETAINING WALL CAPS

UNIVERSAL CAPS (split-face front/back)

4" Colors: Bluestone, Charcoal, Grey, Sandstone, Sandstone Brown, Santa Fe

3" Colors: Beechwood, Bluestone, Cascade, Grey, Onyx, Santa Fe

CONTEMPORARY CAP (smooth top/sides, beveled edges)

Colors: Mocha, Natural, Onyx

MINI-CAP (split-face front/back)

Colors: Charcoal, Grey, Sandstone, Sandstone Brown

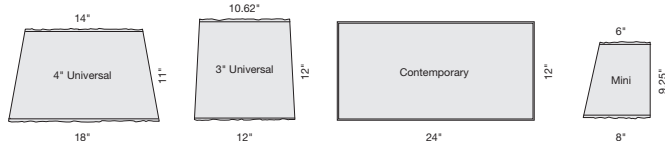

Blocks	Dimensions	Face	Weight	Units/Layer	Layers	Units/Pallet	Pallet Weight
4" Universal*	18/14 x 11 x 4" H	1.33 In. ft.	54 lbs.	9	5	45 (60 In. ft.)	2,480 lbs.
3" Universal	12/10.62 x 12 x 3" H	0.94 In. ft.	26 lbs.	12	4	48 (45 In. ft.)	1,298 lbs.
Contemporary Cap	24 x 12 x 2-3/8" H	2 In. ft.	50 lbs.	6	8	48 (96 In. ft.)	2,450 lbs.
Mini-Cap**	8/6 x 9.25 x 3" H	0.67 In. ft.	15.2 lbs.	52	2	104 (60 In. ft.)	1,630 lbs.

*To estimate 4" Universal Cap, divide wall length by 1.33 **To estimate Mini-Cap, divide wall length by 0.67.

Dimensions shown are nominal.

	BEECHWOOD	BLUESTONE	BUFF	CAFE	CASCADE	CARMEL	CHARCOAL	COPPER CANYON	FOND DU LAC	GREY	MOCHA	MOONLIGHT GRAY	NATURAL	ONYX	PACIFIC GREY	SANDSTONE	SANDSTONE BROWN	SANTA FE
CLASSIC 6		●					●			●						●	●	●
CLASSIC 6 BEVELED		●															●	●
CLASSIC 8							●			●						●	●	
CLASSIC 8 BEVELED										●						●		
CLASSIC 8 DOT										●						●		
CLASSIC COLONIAL 6		●															●	●
CLASSIC COLONIAL 8																		
CONTEMPORARY	●				●									●				
COTTAGE STONE & CAP							●			●						●	●	
KODAH / OUTCROPPING								●	●						●			
LAKELAND	○	○			○									○				○
OLYMPIC	●				●									●				
PALISADE				●	●													
PREMIER 6		●			●									●				
PREMIER 8							●			●						●	●	
RIVERLAND	○	○			○									○				○
VINTAGE 6	●	●			●													●
VINTAGE 6 TUMBLED	●	●			●													●
VERSA-LOK STANDARD			●			●						●						

● = Chroma Color Facemix Technology

○ = Tumbled



Manufactured by:

Rochester
Concrete Products™

7200 Broadway Ave. N, Rochester, MN 55906
Phone: 507-288-8850 / rochesterpcp.com

©Copyright 2026. All Rights Reserved. This information has been prepared for the benefit of customers interested in Rochester Concrete Products. It was reviewed carefully prior to publication. Rochester Concrete Products assumes no liability for its accuracy or completeness. Final determination of the suitability of any information or material for the use contemplated, or for its manner of use, is the sole responsibility of the user. 126

